

TELESCOPE CONTROL BUILDING (9c)

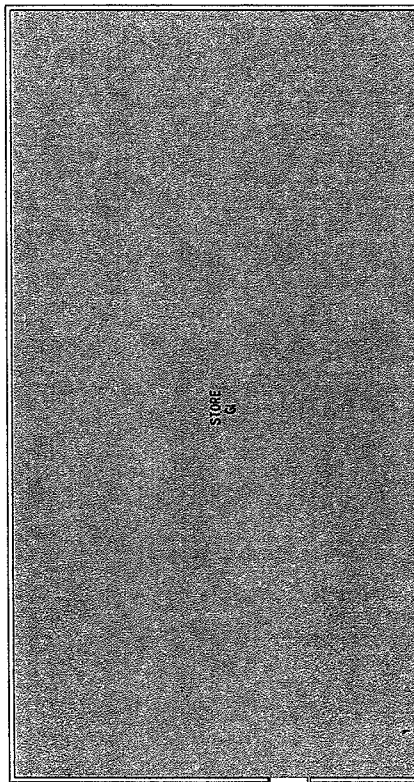

OLD TELESCOPE BUILDING (9a)



PHYSICS



The contractor must verify all dimensions and locations before commencing work. All dimensions are given by Property Services.

Scale 1:1000

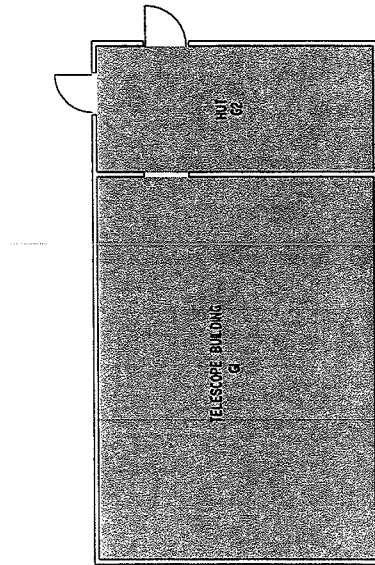

TELESCOPE FACILITY (9b)

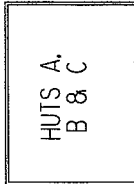
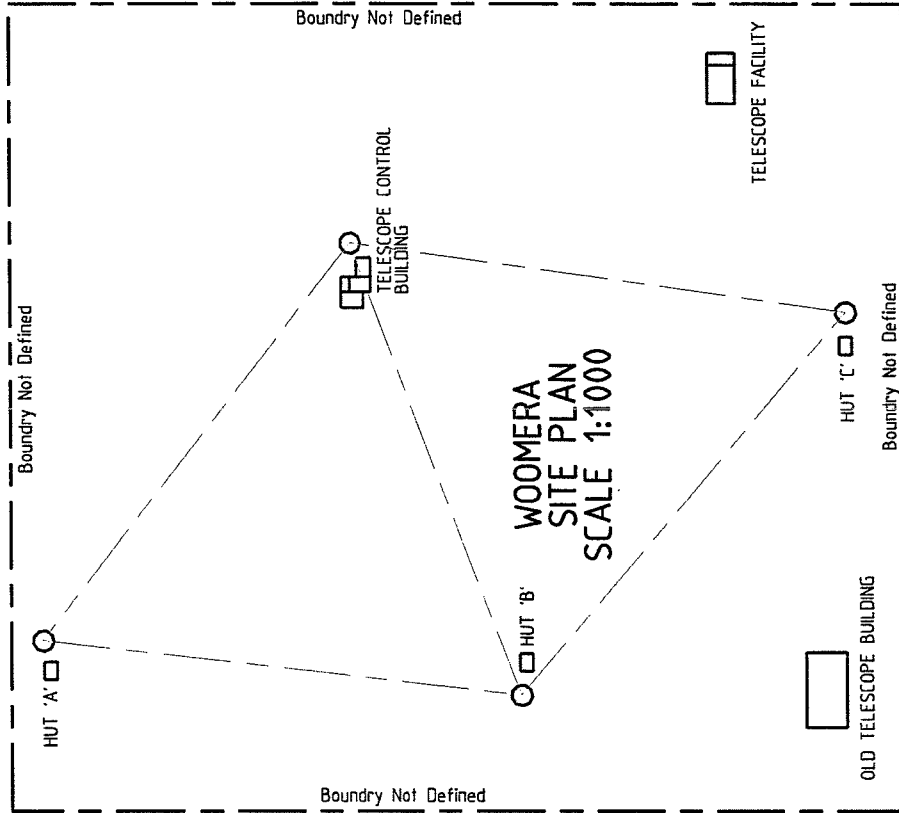

WOOMERA DIRECTIONS
ALL Persons need to be accompanied by officer, to site as 'RESTRICTED AREA' and difficult to find.
Contact Greg Thornton or Dr Roger Clay to obtain Access Permission before leaving OR Flat 303 contains Japanese Partners who can direct to site. This is a block of huts, 2 buildings South of the DSCW Administration building. They may not have access to all buildings.

ADVICE
Dept. of Physics - 8303 6335
- Greg Thornton 8303 5046
- Roger Clay

CONTACTS
Bruce Henderson (08) 8674 3211
Fax (08) 8674 3308
at DSCW Administration Building
Oppos. Woomera District Hospital

C ARCH CONTACT & TITLE DETAILS
D ARCH CONTACT DETAILS
A NEW DRAWING

APR 95
FEB 95
JUN 92

THE UNIVERSITY OF ADELAIDE
PROPERTY SERVICES
100 North East Street
Adelaide South Australia 5005
Telephone: (08) 830 3200
Facsimile: (08) 830 3200
E-mail: pss@adelaide.edu.au

Document

FIELD STATION (9)
SPACE PLAN
WOOMERA
BUILDINGS: 9a-9c
& SITE PLAN

Drawn	B.D.K.	Area	
Rev	2/7/98	Vol.	
Checked		Job No.	
Date		Drawn By	
Sheet No.			

FS-A-9-01 C

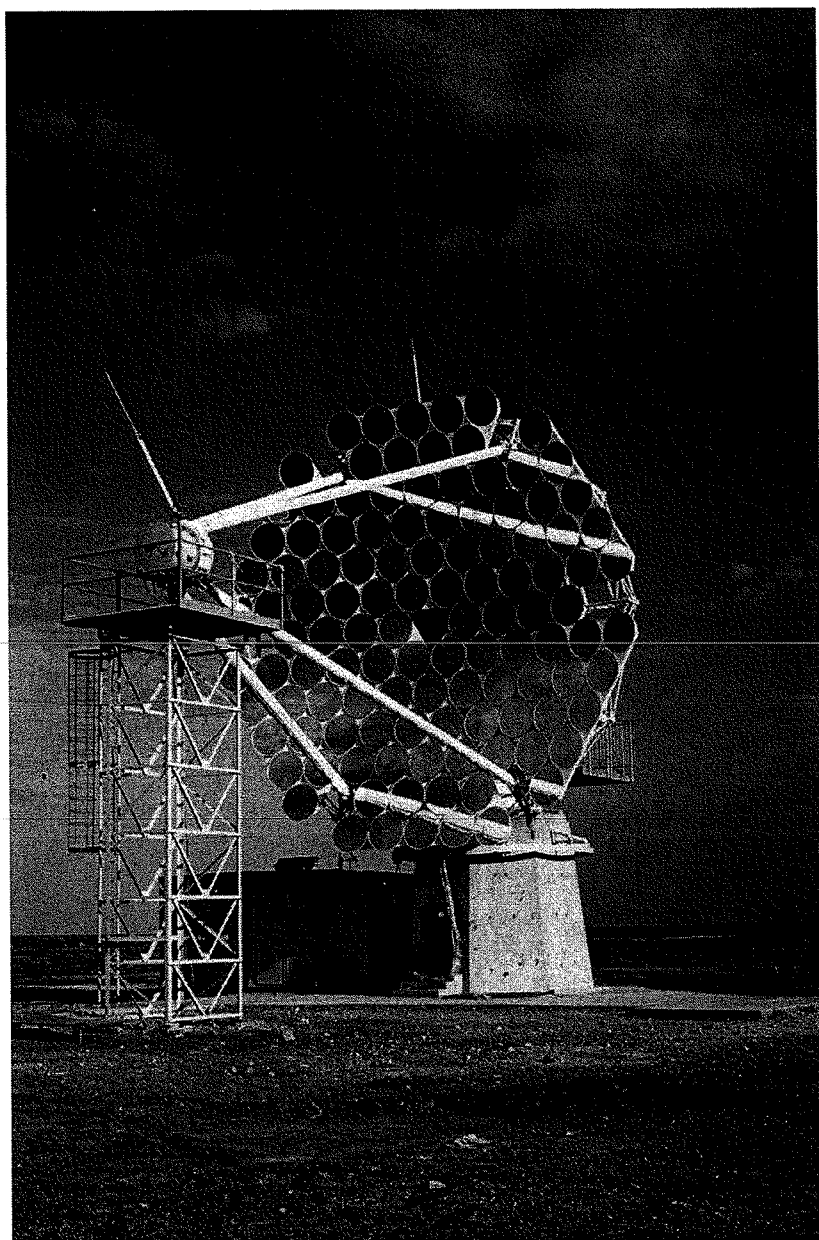



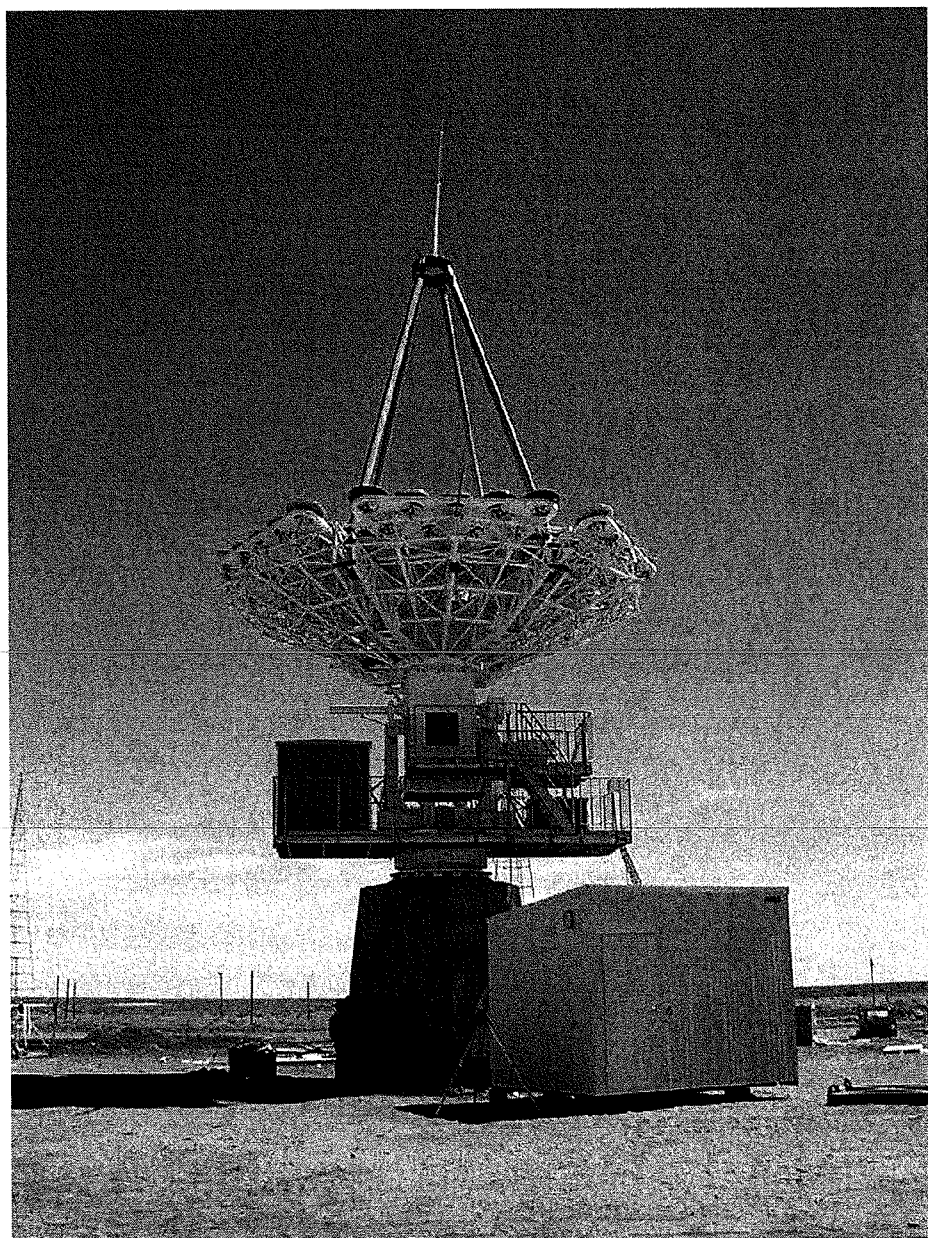

Information Only

GENERAL

SCHEMATIC

FOR DISH

SUPPORT

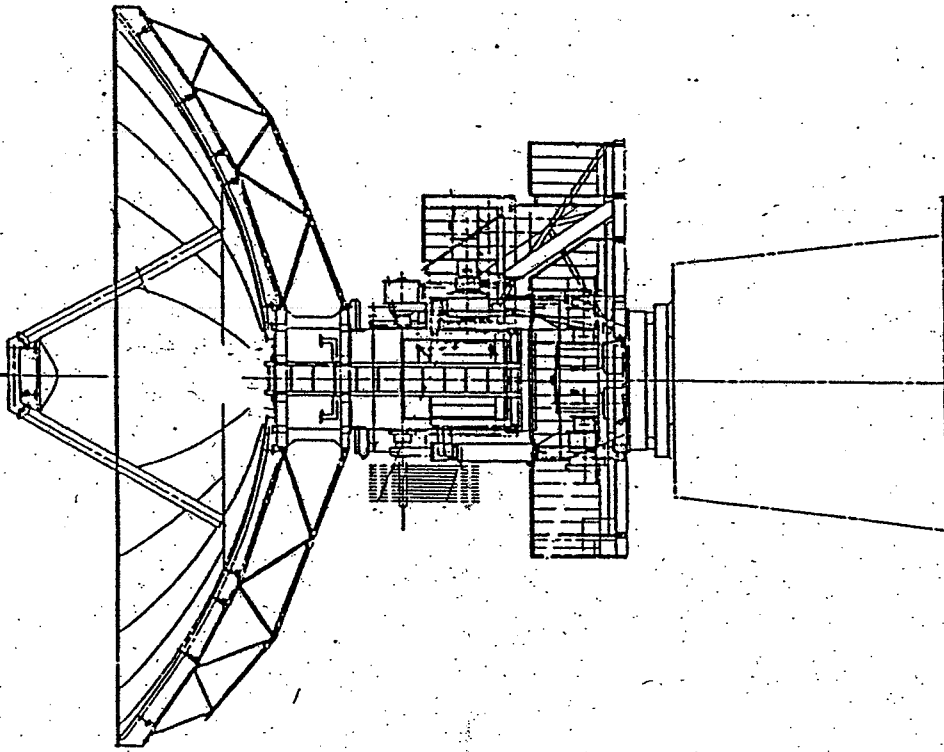

Fig-2.6

A	第三角法		DIMENSION	尺度	SCALE	作成日付	DATE
		IN	mm	NTS	19		
MITSUBISHI ELECTRIC CORPORATION							
APPROVED	DESIGNED	CHECKED	DRAWN				
				アンテナ装置組立要領書 (6/6)			
				アンテナ組み立て完成図			
				R			

改定 CHANGE

